

# Greenspace Flex

## RS378B P15 927 PSU-E NB M55

927 warm white - Electronic transformer - Aluminum and gray

GreenSpace Flex is performance portfolio dedicated to Hospitality segment for GC/GM countries. With modular design concept, the light engines and different trims could have multiply of combination to satisfy diversified customer's requirement.

### Product data

General information		Average CLO power consumption	
Light source color	927 warm white	Average CLO power consumption	650 W
Number of gear units	1 unit	Power Factor (Min)	0.9
Driver/power unit/transformer	Electronic transformer	Controls and dimming	
Driver included	Yes	Dimmable	No
Optical cover/lens type	Lens	Mechanical and housing	
Control interface	-	Housing Material	Aluminum
Connection	External connector	Optic material	Polymethyl methacrylate
Cable	-	Optical cover/lens material	Polymethyl methacrylate
Protection class IEC	Safety class II	Fixation material	Aluminum
Glow-wire test	Temperature 600 °C, duration 30 s	Optical cover/lens finish	-
CE mark	CE mark	Overall length	0 mm
Warranty period	3 years	Overall width	0 mm
Constant light output	No	Overall height	49 mm
Number of products on MCB of 16 A type B	1	Overall diameter	55 mm
EU RoHS compliant	Yes	Color	Aluminum and gray
Light source engine type	LED	Approval and application	
Operating and electrical		Ingress protection code	IP20 [ Finger-protected]
Input Voltage	220 to 240 V		
Input Frequency	50 or 60 Hz		

## Greenspace Flex

Mech. impact protection code	IK04 [ 0.5 J standard plus]
------------------------------	-----------------------------

### Initial performance (IEC compliant)

Initial luminous flux (system flux)	1140 lm
Luminous flux tolerance	+/-10%
Initial LED luminaire efficacy	76 lm/W
Init. Corr. Color Temperature	2700 K
Init. Color Rendering Index	≥90
Initial chromaticity	SDCM<3
Initial input power	15 W
Power consumption tolerance	+/-10%

### Over time performance (IEC compliant)

Median useful life L80B50	50000 h
---------------------------	---------

### Application conditions

Ambient temperature range	-20 to +45 °C
---------------------------	---------------

Maximum dim level	Not applicable
Suitable for random switching	No

### Product data

Full product code	911401721252
Order product name	RS378B P15 927 PSU-E NB M55
Order code	911401721252
Numerator - Quantity Per Pack	1
Numerator - Packs per outer box	48
Material Nr. (12NC)	911401721252
Copy Net Weight (Piece)	0.260 kg



## Dimensional drawing

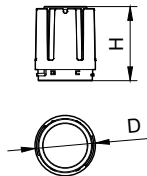

Modular Type	D, mm	H, mm
RS378B P6/P11 M55	55	49
RS378B P15 M55	55	49
RS378B P24 M70	70	90
RS378B P33 M87	87	107
RS378B P42 M102	102	116

RS378B P15 927 PSU-E NB M55

