

# Greenspace Flex

## RS378B P15 940 PSU-E NB M55

940 neutral white - Electronic transformer - Gray

GreenSpace Flex is performance portfolio dedicated to Hospitality segment for GC/GM countries. With modular design concept, the light engines and different trims could have multiply of combination to satisfy diversified customer's requirement.

### Product data

| General information                      |                                   |
|--|-----------------------------------|
| Light source color                       | 940 neutral white                 |
| Number of gear units                     | 1 unit                            |
| Driver/power unit/transformer            | Electronic transformer            |
| Driver included                          | Yes                               |
| Optical cover/lens type                  | Lens                              |
| Control interface                        | -                                 |
| Connection                               | External connector                |
| Cable                                    | -                                 |
| Protection class IEC                     | Safety class II                   |
| Glow-wire test                           | Temperature 600 °C, duration 30 s |
| CE mark                                  | CE mark                           |
| Warranty period                          | 3 years                           |
| Constant light output                    | No                                |
| Number of products on MCB of 16 A type B | 40                                |
| EU RoHS compliant                        | Yes                               |
| Light source engine type                 | LED                               |
| Operating and electrical                 |                                   |
| Input Voltage                            | 220 to 240 V                      |
| Input Frequency                          | 50 to 60 Hz                       |

| Average CLO power consumption | 785 W                    |
|-------------------------------|--------------------------|
| Power Factor (Min)            | 0.9                      |
| Controls and dimming          |                          |
| Dimmable                      | No                       |
| Mechanical and housing        |                          |
| Housing Material              | Aluminum                 |
| Optic material                | Polymethyl methacrylate  |
| Optical cover/lens material   | Acrylate                 |
| Fixation material             | Aluminum                 |
| Optical cover/lens finish     | Textured                 |
| Overall length                | 0 mm                     |
| Overall width                 | 0 mm                     |
| Overall height                | 72 mm                    |
| Overall diameter              | 55 mm                    |
| Color                         | Gray                     |
| Approval and application      |                          |
| Ingress protection code       | IP20 [ Finger-protected] |

## Greenspace Flex

|                              |                             |
|------------------------------|-----------------------------|
| Mech. impact protection code | IK04 [ 0.5 J standard plus] |
|------------------------------|-----------------------------|

### Initial performance (IEC compliant)

|                                     |         |
|-------------------------------------|---------|
| Initial luminous flux (system flux) | 1305 lm |
| Luminous flux tolerance             | +/-10%  |
| Initial LED luminaire efficacy      | 87 lm/W |
| Init. Corr. Color Temperature       | 4000 K  |
| Init. Color Rendering Index         | >90     |
| Initial chromaticity                | SDCM<3  |
| Initial input power                 | 15 W    |
| Power consumption tolerance         | +/-10%  |

### Over time performance (IEC compliant)

|                           |         |
|---------------------------|---------|
| Median useful life L80B50 | 50000 h |
|---------------------------|---------|

### Application conditions

|                           |               |
|---------------------------|---------------|
| Ambient temperature range | -20 to +45 °C |
|---------------------------|---------------|

|                   |                |
|-------------------|----------------|
| Maximum dim level | Not applicable |
|-------------------|----------------|

|                               |    |
|-------------------------------|----|
| Suitable for random switching | No |
|-------------------------------|----|

### Product data

|                   |              |
|-------------------|--------------|
| Full product code | 911401721272 |
|-------------------|--------------|

|                    |                             |
|--------------------|-----------------------------|
| Order product name | RS378B P15 940 PSU-E NB M55 |
|--------------------|-----------------------------|

|            |              |
|------------|--------------|
| Order code | 911401721272 |
|------------|--------------|

|                               |   |
|-------------------------------|---|
| Numerator - Quantity Per Pack | 1 |
|-------------------------------|---|

|                                 |    |
|---------------------------------|----|
| Numerator - Packs per outer box | 48 |
|---------------------------------|----|

|                     |              |
|---------------------|--------------|
| Material Nr. (12NC) | 911401721272 |
|---------------------|--------------|

|                         |          |
|-------------------------|----------|
| Copy Net Weight (Piece) | 0.260 kg |
|-------------------------|----------|



## Dimensional drawing

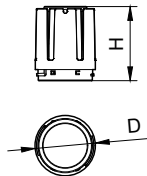

| Modular Type      | D, mm | H, mm |
|-------------------|-------|-------|
| RS378B P6/P11 M55 | 55    | 49    |
| RS378B P15 M55    | 55    | 49    |
| RS378B P24 M70    | 70    | 90    |
| RS378B P33 M87    | 87    | 107   |
| RS378B P42 M102   | 102   | 116   |

RS378B P15 940 PSU-E NB M55

