

# Greenspace Flex

## RS378B P24 940 PSU-E WB M70

940 neutral white - Electronic transformer - Gray

GreenSpace Flex is performance portfolio dedicated to Hospitality segment for GC/GM countries. With modular design concept, the light engines and different trims could have multiply of combination to satisfy diversified customer's requirement.

### Product data

General information	
Light source color	940 neutral white
Number of gear units	1 unit
Driver/power unit/transformer	Electronic transformer
Driver included	Yes
Optical cover/lens type	Lens
Luminaire light beam spread	40°
Control interface	-
Connection	External connector
Cable	-
Protection class IEC	Safety class II
Glow-wire test	Temperature 600 °C, duration 30 s
CE mark	CE mark
Warranty period	3 years
Constant light output	No
Number of products on MCB of 16 A type B	40
EU RoHS compliant	Yes
Light source engine type	LED

Operating and electrical	
Input Voltage	220 to 240 V

Input Frequency	50 to 60 Hz
Average CLO power consumption	2085 W
Power Factor (Min)	0.9

Controls and dimming	
Dimmable	No

Mechanical and housing	
Housing Material	Aluminum
Optic material	Polymethyl methacrylate
Optical cover/lens material	Acrylate
Fixation material	Aluminum
Optical cover/lens finish	Textured
Overall length	0 mm
Overall width	0 mm
Overall height	90 mm
Overall diameter	70 mm
Color	Gray

Approval and application	
Ingress protection code	IP20 [ Finger-protected]

## Greenspace Flex

Mech. impact protection code	IK04 [ 0.5 J standard plus]
------------------------------	-----------------------------

### Initial performance (IEC compliant)

Initial luminous flux (system flux)	2232 lm
Luminous flux tolerance	+/-10%
Initial LED luminaire efficacy	93 lm/W
Init. Corr. Color Temperature	4000 K
Init. Color Rendering Index	>90
Initial chromaticity	SDCM<3
Initial input power	24 W
Power consumption tolerance	+/-10%

### Over time performance (IEC compliant)

Median useful life L80B50	50000 h
---------------------------	---------

### Application conditions

Ambient temperature range	-20 to +45 °C
---------------------------	---------------

Maximum dim level	Not applicable
-------------------	----------------

Suitable for random switching	No
-------------------------------	----

### Product data

Full product code	911401721512
-------------------	--------------

Order product name	RS378B P24 940 PSU-E WB M70
--------------------	-----------------------------

Order code	911401721512
------------	--------------

Numerator - Quantity Per Pack	1
-------------------------------	---

Numerator - Packs per outer box	36
---------------------------------	----

Material Nr. (12NC)	911401721512
---------------------	--------------

Copy Net Weight (Piece)	0.470 kg
-------------------------	----------



## Dimensional drawing

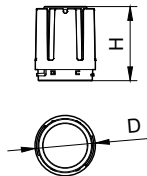

Modular Type	D, mm	H, mm
RS378B P6/P11 M55	55	49
RS378B P15 M55	55	49
RS378B P24 M70	70	90
RS378B P33 M87	87	107
RS378B P42 M102	102	116

RS378B P24 940 PSU-E WB M70

