



Greenspace Flex

RS378B P33 927 PSU-E WB M87

927 warm white - Electronic transformer - Gray

GreenSpace Flex is performance portfolio dedicated to Hospitality segment for GC/GM countries. With modular design concept, the light engines and different trims could have multiply of combination to satisfy diversified customer's requirement.

Product data

General information	
Light source color	927 warm white
Number of gear units	1 unit
Driver/power unit/transformer	Electronic transformer
Driver included	Yes
Optical cover/lens type	Lens
Luminaire light beam spread	40°
Control interface	-
Connection	External connector
Cable	-
Protection class IEC	Safety class II
Glow-wire test	Temperature 600 °C, duration 30 s
CE mark	CE mark
Warranty period	3 years
Constant light output	No
Number of products on MCB of 16 A type B	40
EU RoHS compliant	Yes
Light source engine type	LED

Operating and electrical

Input Voltage	220 to 240 V
---------------	--------------

Input Frequency	50 to 60 Hz
Average CLO power consumption	2150 W
Power Factor (Min)	0.9

Controls and dimming

Dimmable	No
----------	----

Mechanical and housing

Housing Material	Aluminum
Optic material	Polymethyl methacrylate
Optical cover/lens material	Acrylate
Fixation material	Aluminum
Optical cover/lens finish	Textured
Overall length	0 mm
Overall width	0 mm
Overall height	107 mm
Overall diameter	87 mm
Color	Gray

Approval and application

Ingress protection code	IP20 [Finger-protected]
-------------------------	--------------------------

Greenspace Flex

Mech. impact protection code	IK04 [0.5 J standard plus]
------------------------------	-----------------------------

Initial performance (IEC compliant)

Initial luminous flux (system flux)	2640 lm
Luminous flux tolerance	+/-10%
Initial LED luminaire efficacy	80 lm/W
Init. Corr. Color Temperature	2700 K
Init. Color Rendering Index	>90
Initial chromaticity	SDCM<3
Initial input power	33 W
Power consumption tolerance	+/-10%

Over time performance (IEC compliant)

Median useful life L80B50	50000 h
---------------------------	---------

Application conditions

Ambient temperature range	-20 to +45 °C
---------------------------	---------------

Maximum dim level	Not applicable
-------------------	----------------

Suitable for random switching	No
-------------------------------	----

Product data

Full product code	911401721582
-------------------	--------------

Order product name	RS378B P33 927 PSU-E WB M87
--------------------	-----------------------------

Order code	911401721582
------------	--------------

Numerator - Quantity Per Pack	1
-------------------------------	---

Numerator - Packs per outer box	18
---------------------------------	----

Material Nr. (12NC)	911401721582
---------------------	--------------

Copy Net Weight (Piece)	0.730 kg
-------------------------	----------



Dimensional drawing

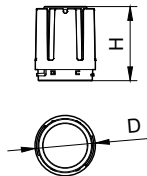

Modular Type	D, mm	H, mm
RS378B P6/P11 M55	55	49
RS378B P15 M55	55	49
RS378B P24 M70	70	90
RS378B P33 M87	87	107
RS378B P42 M102	102	116

RS378B P33 927 PSU-E WB M87

