

Greenspace Flex

RS378B P6 940 PSR-E NB M55

940 neutral white - Electronic transformer - Gray

GreenSpace Flex is performance portfolio dedicated to Hospitality segment for GC/GM countries. With modular design concept, the light engines and different trims could have multiply of combination to satisfy diversified customer's requirement.

Product data

General information	
Light source color	940 neutral white
Number of gear units	1 unit
Driver/power unit/transformer	Electronic transformer
Driver included	Yes
Optical cover/lens type	Lens
Control interface	-
Connection	External connector
Cable	-
Protection class IEC	Safety class II
Glow-wire test	Temperature 600 °C, duration 30 s
CE mark	CE mark
Warranty period	3 years
Constant light output	No
Number of products on MCB of 16 A type B	-
EU RoHS compliant	Yes
Light source engine type	LED
Operating and electrical	
Input Voltage	220 to 240 V
Input Frequency	50 to 60 Hz

Average CLO power consumption	470 W
Power Factor (Min)	0.5
Controls and dimming	
Dimmable	Yes
Mechanical and housing	
Housing Material	Aluminum
Optic material	Polymethyl methacrylate
Optical cover/lens material	Acrylate
Fixation material	Aluminum
Optical cover/lens finish	Textured
Overall length	0 mm
Overall width	0 mm
Overall height	49 mm
Overall diameter	55 mm
Color	Gray
Approval and application	
Ingress protection code	IP20 [Finger-protected]

Greenspace Flex

Mech. impact protection code	IK04 [0.5 J standard plus]
------------------------------	-----------------------------

Initial performance (IEC compliant)

Initial luminous flux (system flux)	522 lm
Luminous flux tolerance	+/-10%
Initial LED luminaire efficacy	87 lm/W
Init. Corr. Color Temperature	4000 K
Init. Color Rendering Index	>90
Initial chromaticity	SDCM<3
Initial input power	6 W
Power consumption tolerance	+/-10%

Over time performance (IEC compliant)

Median useful life L80B50	50000 h
---------------------------	---------

Application conditions

Ambient temperature range	-20 to +45 °C
---------------------------	---------------

Maximum dim level	10%
Suitable for random switching	No

Product data

Full product code	911401721092
Order product name	RS378B P6 940 PSR-E NB M55
Order code	911401721092
Numerator - Quantity Per Pack	1
Numerator - Packs per outer box	48
Material Nr. (12NC)	911401721092
Copy Net Weight (Piece)	0.190 kg



Dimensional drawing

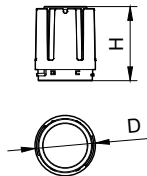

Modular Type	D, mm	H, mm
RS378B P6/P11 M55	55	49
RS378B P15 M55	55	49
RS378B P24 M70	70	90
RS378B P33 M87	87	107
RS378B P42 M102	102	116

RS378B P6 940 PSR-E NB M55

