



# GreenUp Round Highbay

## BY518P LED300/CW PSU NB GM

Lens -

The GreenUp Round Highbay range of luminaires provides the optimal balance between basic performance and price. The family covers a wide product range with a variety of options, competitive specifications, and long-term quality and reliability. The range is suitable for most industrial applications.

### Product data

General information	
Light source color	865 cool daylight
Optical cover/lens type	Lens
Control interface	-
Protection class IEC	Safety class I
CE mark	CE mark
Number of products on MCB of 16 A type B 6	
Light source engine type	LED
Operating and electrical	
Input Voltage	220-240 V
Input Frequency	50 or 60 Hz
Inrush current	0.88 A
Power Factor (Min)	0.95
Controls and dimming	
Dimmable	No

Mechanical and housing	
Housing Material	Aluminum
Optical cover/lens material	Polycarbonate
Optical cover/lens finish	Matte
Overall height	99 mm
Overall diameter	416 mm
Effective projected area	0.06 m <sup>2</sup>
Color	Gray
Approval and application	
Ingress protection code	IP65 [ Dust penetration-protected, jet-proof]
Mech. impact protection code	IK06 [ 1 J]
Initial performance (IEC compliant)	
Initial luminous flux (system flux)	30000 lm
Luminous flux tolerance	+/-10%
Initial LED luminaire efficacy	143 lm/W

## GreenUp Round Highbay

Init. Corr. Color Temperature	6500 K
Init. Color Rendering Index	>80
Initial chromaticity	(0.316, 0.332) SDCM<5
Initial input power	207 W
Power consumption tolerance	+/-10%

### Application conditions

Ambient temperature range	-20 to +45 °C
---------------------------	---------------

### Product data

Full product code	871951453651799
-------------------	-----------------

Order product name	BY518P LED300/CW PSU NB GM
EAN/UPC - Product	8719514536517
Order code	911401648707
Numerator - Quantity Per Pack	1
Numerator - Packs per outer box	2
Material Nr. (12NC)	911401648707
Copy Net Weight (Piece)	3.690 kg

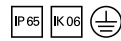

## Dimensional drawing

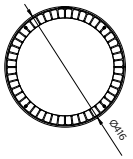

BY518P LED300/CW PSU NB GM

