

# SmartBright LED Floodlight

## BVP176 LED220/CW 200W WB GREY CE

22000 lm - 200 W - 5700 K

The SmartBright LED Floodlight is a versatile floodlight engineered to deliver significant energy savings, an ideal solution for diverse floodlighting applications. The product is also designed to meet relevant performance and safety standards, offering you reliable and long-lasting performance.

### Product data

General information	
Lamp colour code	757 cool white
Driver included	No
Optical cover/lens type	PC [ Polycarbonate bowl/cover]
Control interface	-
Connection	Flying leads/wires
Cable	Cord 0.6 m without plug
Protection class IEC	Safety class I (I)
Flammability mark	F [ For mounting on normally flammable surfaces]
CE mark	CE mark

Operating and electrical	
Input Voltage	220 to 240 V
Input frequency	50 or 60 Hz
Power factor (min.)	0.95

Controls and dimming	
Dimmable	No

Mechanical and housing	
Housing material	Aluminum die-cast
Optical cover/lens material	Polycarbonate
Overall length	390 mm
Overall width	290 mm
Overall height	65 mm
Effective projected area	0.102 m <sup>2</sup>
Colour	Dark Grey

Approval and application	
Ingress protection code	IP65 [ Dust penetration-protected, jet-proof]
Mech. impact protection code	IK07 [ 2 J reinforced]

Initial performance (IEC compliant)	
Initial luminous flux (system flux)	22000 lm

# SmartBright LED Floodlight

Luminous flux tolerance	+/-10%
Initial LED luminaire efficacy	115 lm/W
Lamp colour temperature	5700 K
Colour Rendering Index	>80
Initial chromaticity	(0.33, 0.34) SDCM<7
Initial input power	200 W
Power consumption tolerance	+/-10%

## Application conditions

Ambient temperature range	-40 to +45 °C
---------------------------	---------------

## Product data

Full product code	871951454652399
-------------------	-----------------

Order product name	BVP176 LED220/CW 200W WB GREY CE
EAN/UPC – product	8719514546523
Order code	911401687007
SAP numerator – quantity per pack	1
Numerator – packs per outer box	3
SAP material	911401687007
Net Weight (Piece)	4.690 kg



## Dimensional drawing

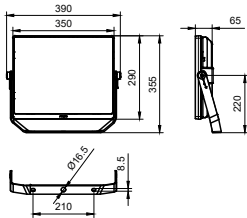

BVP176 LED220/CW 200W WB GREY CE

