



UNIBollard

BCP312 LED760/WW 15W 100-240V Cyl BK

UNIBollard - 760 lm - 15 W - 3000 K

UNIBollard is dedicated to light up public environments of park, buildings outside area, compound areas to bring you a more bright light in evening with the safety and convenience. Its graceful appearance is also a part of public scenery to beautify area you live.

Warnings and Safety

- Use additional surge protection device in electrical circuit for lighting wiring.

Product data

General information	
Light source color	830 warm white
Light source replaceable	No
Driver included	Yes
Optical cover/lens type	Polycarbonate bowl/cover frosted
Control interface	-
Connection	Screw connection block 3-pole
Cable	Cable 0.3 m with connector 3-pole
Protection class IEC	Safety class I
Flammability mark	-
CE mark	-
Light source engine type	LED
Serviceability class	Class C, luminaire without serviceable parts, not serviceable

Light technical

Standard tilt angle posttop	-
-----------------------------	---

Operating and electrical	
Input Voltage	100 to 240 V
Input Frequency	50 or 60 Hz
Power Factor (Min)	0.9

Controls and dimming

Dimmable	No
----------	----

Mechanical and housing

Housing Material	Aluminum
Optic material	Polycarbonate
Optical cover/lens material	Polycarbonate
Mounting device	Baseplate
Optical cover/lens finish	Frosted
Overall height	1200 mm
Overall diameter	160 mm
Color	Black and aluminum

Approval and application

Ingress protection code	IP65 [Dust penetration-protected, jet-proof]
Mech. impact protection code	IK06 [1 J]

Initial performance (IEC compliant)

Initial luminous flux (system flux)	760 lm
Luminous flux tolerance	+/-10%
Initial LED luminaire efficacy	40 lm/W
Init. Corr. Color Temperature	3000 K
Init. Color Rendering Index	>80
Initial input power	15 W
Power consumption tolerance	+/-10%

Application conditions

Ambient temperature range	-40 to +50 °C
---------------------------	---------------

Product data

Full product code	911401755282
Order product name	BCP312 LED760/WW 15W 100-240V Cyl BK
Order code	911401755282
Numerator - Quantity Per Pack	1
Numerator - Packs per outer box	2
Material Nr. (12NC)	911401755282
Copy Net Weight (Piece)	3.500 kg



Dimensional drawing

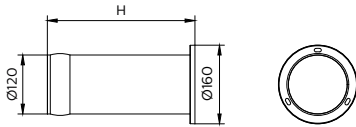

	H/mm
BCP310	300
BCP311	600
BCP312	1000

BCP312 LED760/WW 15W 100-240V Cyl BK

