



# Greenspace Flex

## RS378B P11 930 PSR-E NB M55

Greenspace Flex, 11 W, 930 warm white, Phase-cut dim, IP20 |  
Finger-protected

GreenSpace Flex is performance portfolio dedicated to Hospitality segment for GC/GM countries. With modular design concept, the light engines and different trims could have multiply of combination to satisfy diversified customer's requirement.

### Product data

General Information	
Number of gear units	1 unit
Driver included	Yes
Light source engine type	LED
Warranty period	3 years
Light Technical	
Luminous Flux	836 lm
Correlated Color Temperature (Nom)	3000 K
Luminous Efficacy (rated) (Nom)	76 lm/W
Color rendering index (CRI)	>90
Light source color	930 warm white
Operating and Electrical	
Input Voltage	220-240 V
Line Frequency	50 or 60 Hz
Average CLO power consumption	570 W
Power Consumption	11 W
Power Factor (Fraction)	0.9
Connection	External connector

Cable	-
Number of products on MCB of 16 A type B	-
Suitable for random switching	No
Protection class IEC	Safety class II
Controls and Dimming	
Dimmable	TRIAC
Driver/power unit/transformer	Electronic transformer
Control interface	Phase-cut dim
Constant light output	No
Maximum dim level	10%
Mechanical and Housing	
Housing Material	Aluminum Alloy
Optic material	Polymethyl methacrylate
Optical cover material	Polymethyl methacrylate
Fixation material	Aluminum
Housing Color	Grey
Optical cover finish	Opal
Overall length	0 mm

# Greenspace Flex

Overall width	0 mm
Overall height	49 mm
Overall diameter	55 mm
Dimensions (Height x Width x Depth)	49 x 0 x 0 mm
Ingress protection code	IP20 [Finger-protected]
Mech. impact protection code	IK04 [0.5 J standard plus]
Optical cover type	PMMA
Net Weight (Piece)	0.220 kg

## Approval and Application

Glow-wire test	Temperature 600 °C, duration 30 s
CE mark	Yes
EU RoHS compliant	Yes
Ambient temperature range	-20 to +45 °C

## Initial Performance (IEC Compliant)

Luminous flux tolerance	-10% / +10%
-------------------------	-------------

Initial chromaticity	SDCM<3
Power consumption tolerance	+/-10%

## Over Time Performance (IEC Compliant)

Median useful life L80B50	50,000 hour(s)
---------------------------	----------------

## Product Data

Order product name	RS378B P11 930 PSR-E NB M55
Full product name	RS378B P11 930 PSR-E NB M55
Full product code	911401721172
Order code	911401721172
Material Nr. (12NC)	911401721172
Numerator - Quantity Per Pack	1
Numerator - Packs per outer box	48

## Dimensional drawing

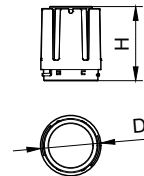
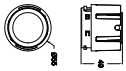

Modular Type	D, mm	H, mm
RS378B P6/P11 M55	55	49
RS378B P15 M55	55	49
RS378B P24 M70	70	90
RS378B P33 M87	87	107
RS378B P42 M102	102	116

