



Greenspace Flex

RS378B P15 927 PSU-E NB M55

Greenspace Flex, 15 W, 927 warm white, IP20 | Finger-protected

GreenSpace Flex is performance portfolio dedicated to Hospitality segment for GC/GM countries. With modular design concept, the light engines and different trims could have multiply of combination to satisfy diversified customer's requirement.

Product data

General Information		Number of products on MCB of 16 A type B	
Number of gear units	1 unit	Suitable for random switching	No
Driver included	Yes	Protection class IEC	Safety class II
Light source engine type	LED	Controls and Dimming	
Warranty period	3 years	Dimmable	No
Light Technical		Driver/power unit/transformer	Electronic transformer
Luminous Flux	510 lm	Control interface	-
Correlated Color Temperature (Nom)	2700 K	Constant light output	No
Luminous Efficacy (rated) (Nom)	85 lm/W	Maximum dim level	Not applicable
Color rendering index (CRI)	>90	Mechanical and Housing	
Light source color	927 warm white	Housing Material	Aluminum Alloy
Operating and Electrical		Optic material	Polymethyl methacrylate
Input Voltage	220-240 V	Optical cover material	Polymethyl methacrylate
Line Frequency	50 or 60 Hz	Fixation material	Aluminum
Average CLO power consumption	650 W	Housing Color	Grey
Power Consumption	15 W	Optical cover finish	Opal
Power Factor (Fraction)	0.9	Overall height	72 mm
Connection	External connector	Overall diameter	55 mm
Cable	-	Ingress protection code	IP20 [Finger-protected]

Greenspace Flex

Mech. impact protection code	IK04 [0.5 J standard plus]
Optical cover type	PMMA
Net Weight (Piece)	0.260 kg

Approval and Application

Glow-wire test	Temperature 600 °C, duration 30 s
CE mark	Yes
EU RoHS compliant	Yes
Ambient temperature range	-20 to +45 °C

Initial Performance (IEC Compliant)

Luminous flux tolerance	-10% / +10%
Initial chromaticity	SDCM<3
Power consumption tolerance	+/-10%

Over Time Performance (IEC Compliant)

Median useful life L80B50	50.000 hour(s)
---------------------------	----------------

Product Data

Order product name	RS378B P15 927 PSU-E NB M55
Full product name	RS378B P15 927 PSU-E NB M55
Full product code	911401721252
Order code	911401721252
Material Nr. (12NC)	911401721252
Numerator - Quantity Per Pack	1
Numerator - Packs per outer box	48

Dimensional drawing

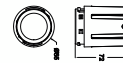
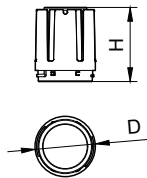

Modular Type	D, mm	H, mm
RS378B P6/P11 M55	55	49
RS378B P15 M55	55	49
RS378B P24 M70	70	90
RS378B P33 M87	87	107
RS378B P42 M102	102	116

