



# GreenSpace Flex

## RS378B P6 930 PSR-E MB M55

GreenSpace Flex, 6 W, 930 warm white, 24°, Phase-cut dim, IP20 | Finger-protected

GreenSpace Flex is performance portfolio dedicated to Hospitality segment for GC/GM countries. With modular design concept, the light engines and different trims could have multiply of combination to satisfy diversified customer's requirement.

### Product data

| General Information                |                | Connection                               |                         |
|------------------------------------|----------------|--|-------------------------|
| Number of gear units               | 1 unit         | Connection                               | External connector      |
| Driver included                    | Yes            | Cable                                    | -                       |
| Light source engine type           | LED            | Number of products on MCB of 16 A type B | -                       |
| Warranty period                    | 3 years        | Suitable for random switching            | No                      |
|                                    |                | Protection class IEC                     | Safety class II         |
| Light Technical                    |                | Controls and Dimming                     |                         |
| Luminous Flux                      | 450 lm         | Dimmable                                 | TRIAC                   |
| Correlated Color Temperature (Nom) | 3000 K         | Driver/power unit/transformer            | Electronic transformer  |
| Luminous Efficacy (rated) (Nom)    | 75 lm/W        | Control interface                        | Phase-cut dim           |
| Color rendering index (CRI)        | >90            | Constant light output                    | No                      |
| Light source color                 | 930 warm white | Maximum dim level                        | 10%                     |
| Luminaire light beam spread        | 24°            |  |                         |
| Operating and Electrical           |                | Mechanical and Housing                   |                         |
| Input Voltage                      | 220-240 V      | Housing Material                         | Aluminum Alloy          |
| Line Frequency                     | 50 or 60 Hz    | Optic material                           | Polymethyl methacrylate |
| Average CLO power consumption      | 390 W          | Optical cover material                   | Polymethyl methacrylate |
| Power Consumption                  | 6 W            | Fixation material                        | Aluminum                |
| Power Factor (Fraction)            | 0.9            | Housing Color                            | Grey                    |
|                                    |                | Optical cover finish                     | Opal                    |

## Greenspace Flex

|                                     |                            |
|-------------------------------------|----------------------------|
| Overall length                      | 0 mm                       |
| Overall width                       | 0 mm                       |
| Overall height                      | 49 mm                      |
| Overall diameter                    | 55 mm                      |
| Dimensions (Height x Width x Depth) | 49 x 0 x 0 mm              |
| Ingress protection code             | IP20 [Finger-protected]    |
| Mech. impact protection code        | IK04 [0.5 J standard plus] |
| Optical cover type                  | PMMA                       |
| Net Weight (Piece)                  | 0.190 kg                   |

### Approval and Application

|                           |                                   |
|---------------------------|-----------------------------------|
| Glow-wire test            | Temperature 600 °C, duration 30 s |
| CE mark                   | Yes                               |
| EU RoHS compliant         | Yes                               |
| Ambient temperature range | -20 to +45 °C                     |

### Initial Performance (IEC Compliant)

|                         |             |
|-------------------------|-------------|
| Luminous flux tolerance | -10% / +10% |
|-------------------------|-------------|

|                             |        |
|-----------------------------|--------|
| Initial chromaticity        | SDCM<3 |
| Power consumption tolerance | +/-10% |

### Over Time Performance (IEC Compliant)

|                           |                |
|---------------------------|----------------|
| Median useful life L80B50 | 50,000 hour(s) |
|---------------------------|----------------|

### Product Data

|                                 |                            |
|---------------------------------|----------------------------|
| Order product name              | RS378B P6 930 PSR-E MB M55 |
| Full product name               | RS378B P6 930 PSR-E MB M55 |
| Full product code               | 911401721112               |
| Order code                      | 911401721112               |
| Material Nr. (12NC)             | 911401721112               |
| Numerator - Quantity Per Pack   | 1                          |
| Numerator - Packs per outer box | 48                         |

## Dimensional drawing

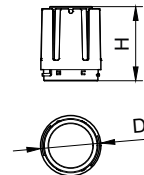
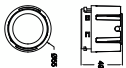

| Modular Type      | D, mm | H, mm |
|-------------------|-------|-------|
| RS378B P6/P11 M55 | 55    | 49    |
| RS378B P15 M55    | 55    | 49    |
| RS378B P24 M70    | 70    | 90    |
| RS378B P33 M87    | 87    | 107   |
| RS378B P42 M102   | 102   | 116   |

